

#### About Allegion

Allegion (NYSE\_ALLE) creates peace of mind by pioneering safety and security. As a \$2 billion provider of security solutions for homes and businesses, Allegion employs more than 8,000 and sells products in more than 120 countries across the world. Allegion comprises 27 global brands, included strategic brand CISA®, Interflex®, LCN®, Schlage® and Von Duprin®.

For more, visit [allegion.com](http://allegion.com)

 BRICARD
  Briton
  CISA
  interflex

**CISA**
**MULTITCP**  
**PRO**
**ELETRICA**

Electric lock for  
aluminium and  
steel doors



**CISA**
**MULTITCP**  
**PRO**  
**ELETRICA**

CISA Multitop Pro Elettrica, **the only electric lock with a 15.5 mm thick case and deadlocking latch**. Ideal for all thermal cut and European groove profiles.

#### HIGH SECURITY

- The deadlocking latch increases security for doors locked with the latchbolt only.
- The locking system with its hook (CISA patent registered) and the deadbolt with its increased thickness (12 mm) guarantee high resistance to forced entry.
- The deadbolts are independent of the central mechanism (a feature that is extremely useful in deterring forced entry).

#### CORRECTS HEAT DISTORTION

The “effort reducing” gear mechanism (that makes it easier to turn the key) and the 12 mm thick deadbolt (with its more rounded design) correct heat distortion of the door caused by environmental factors (e.g. changes in temperature).

**CISA Multitop Pro Elettrica is interchangeable with previously installed versions.**

Visit [cisamultitop.com](http://cisamultitop.com)



#### COVERS

#### THE ENTIRE DOOR

An extension that reaches up to 3,000 mm can be added to the standard faceplate of 2,300 mm. New for the Italian market.

#### BENEFITS:

- Improves aesthetics
- Increases security and hermetically seals the door



#### CORRECTS HEAT DISTORTION

The "effort reducing" gear mechanism that makes it easier to turn the key, and the 12 mm thick deadbolt with its more rounded design, offer an effective solution to close and secure doors subject to heat distortion.

#### BENEFITS:

- Hermetic seal increasing energy savings
- Cuts maintenance times and costs for the installer

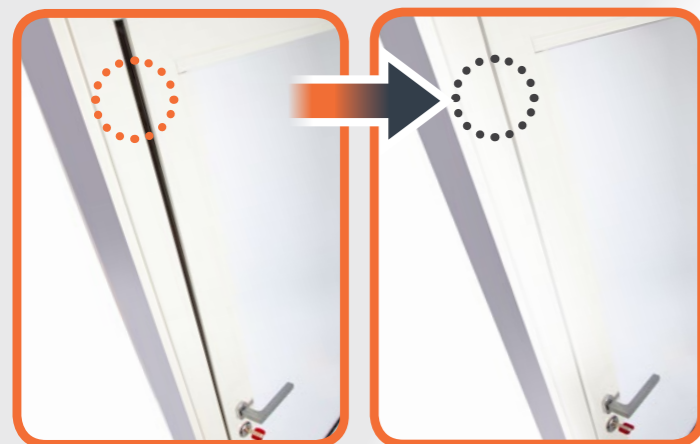

#### ELECTRIC VERSION

The Multitop Pro series offers a complete range of electric locks with a 15.5 mm thick case (as with the mechanical version) and with a deadlocking device on the latchbolt.

#### BENEFITS:

- Fewer holes are needed on the profile and the lock is correctly installed on thermal cut and European groove profiles
- Increases security for doors which are locked with the latchbolt only



#### HIGH SECURITY

- New locking system with hook in hardened steel
- (CISA patent registered)
- Horizontal sliding deadbolt with increased thickness (12 mm)
- Deadbolts independent of the central mechanism
- Deadbolts protected with a hardened steel plate

#### BENEFIT:

- Greater resistance to forced entry



#### INTERCHANGEABILITY

- Interchangeable with previously installed versions
- Backsets from 25 to 40 mm
- Highly compact thanks to the distance from the cylinder (15 mm)
- Centre distances 85 and 92 mm

#### BENEFITS:

- No additional work needed on the door
- Cylinder always correctly positioned
- No holes needed on the back part of the profile during installation

#### DEADLOCKING LATCH

When the door is closed the BOLT retracts, deadlocking the LATCH



#### CASE THICKNESS

The cases are 15.5 mm thick.

#### BENEFIT:

- Fewer holes are needed on the profile and the lock is correctly installed on thermal cut and European groove profiles



#### CLOSED CASE

The lock and divertors cases are enclosed, including the hooks on the rods.

#### BENEFITS:

- Dirt and dust cannot get in
- Eliminates the possibility of damage during installation

#### CERTIFICATIONS

##### Short faceplate version according to European Standard EN 12209:03

- Grade 6 Security: 1,000 kg for lateral thrust and 600 kg for front load (Suitable for EN 1627:2011 certified doors up to resistance class WK/RC3)

##### Long faceplate version according to European Standard prEN 15685:10

- Grade 6 Security: 1,000 kg for lateral thrust and 600 kg for front load (Suitable for EN 1627:2011 certified doors up to resistance class WK/RC3)
- Grade 7 Security: like Grade 6 with the use of protective plates 06436 Series (Suitable for EN 1627:2011 certified doors up to resistance class WK/RC6)



#### FINISHES AVAILABLE

- Faceplate in stainless steel
- Faceplate in black painted stainless steel



# MULTITOP PRO ELETTRICA

#### TOTAL PROTECTION

The lock can be fitted with 4th and 5th locking points

#### BENEFIT:

- Greater security for two-leaf doors

